

# HOIST Series

## 호이스트 스위치

10버튼 호이스트 스위치 (10 button hoist switch)

### 특징(Features)

- 방우형 구조이며 외곽 케이스는 고충격 ABS재질로 가볍고 견고하게 설계 되었습니다.  
(Water-proof structure and outer block case was designed as light and strong by ABS quality of the material that is strong in impact.)
- 조작부는 일반 버튼과 제어용 스위치로 동작 할 수 있도록 설계 되었습니다.  
(The actuator it will be able to operate with button and control switch.)
- 다양한 버튼 명판이 준비되어 있어 용도에 맞추어 선택 사용이 용이합니다.  
(Preparing various button plates. Use is convenient according to usage.)

### 형명 구성 (Name composition)

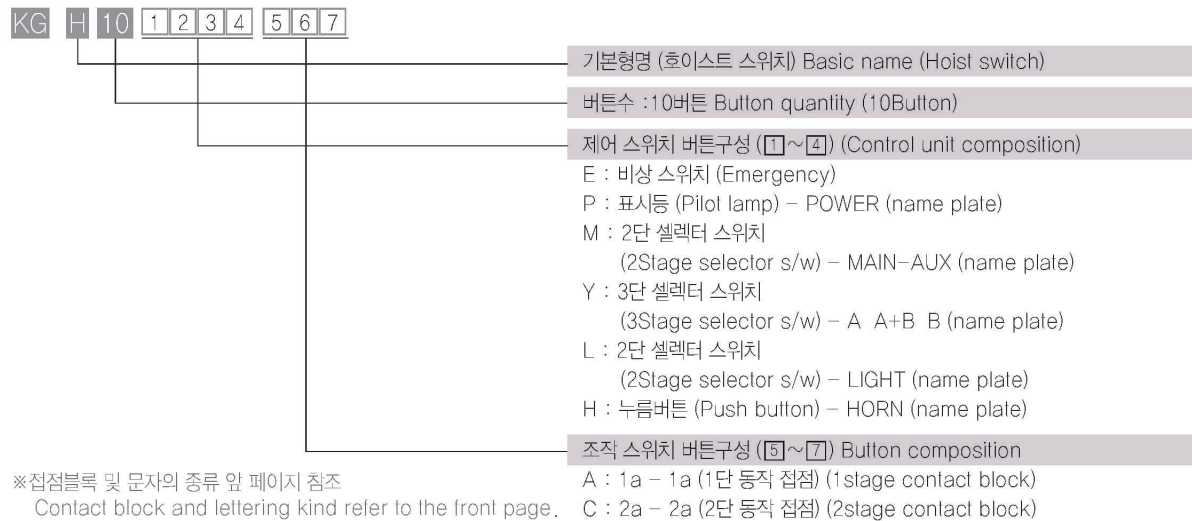

### 제어용 스위치 제품 및 외형도 (Dimensions & Control unit)



표시등 (Pilot lamp)  
(KGP - HV2R) - P(POWER)

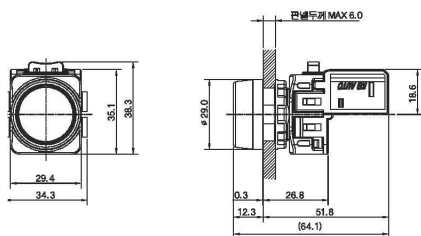

셀렉터 스위치 2단 (Selector s/w 2stage)  
(KGS - H2M1) M(MAIN-AUX), L(LIGHT)

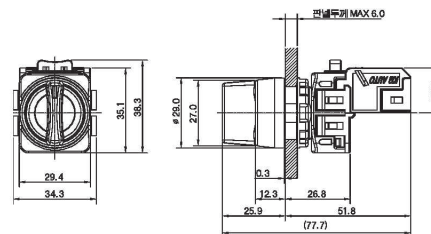

innovate  
now!

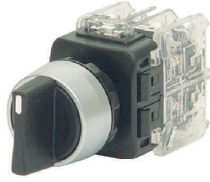

셀렉터 스위치 3단 (Selector s/w 3stage)  
(KGS - H3M2) Y (A A+B B)

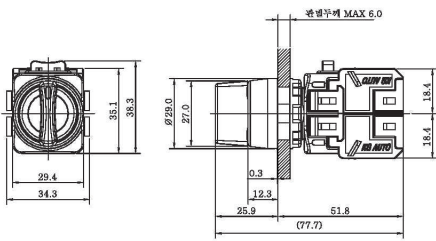

누름버튼 스위치 (Push button)  
(KGF - HM1G) - H(HORN)

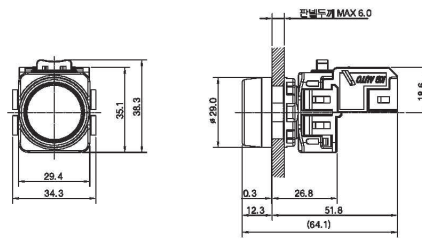

호이스트 스위치 제품 및 외형도 (Dimensions & 10 hole)







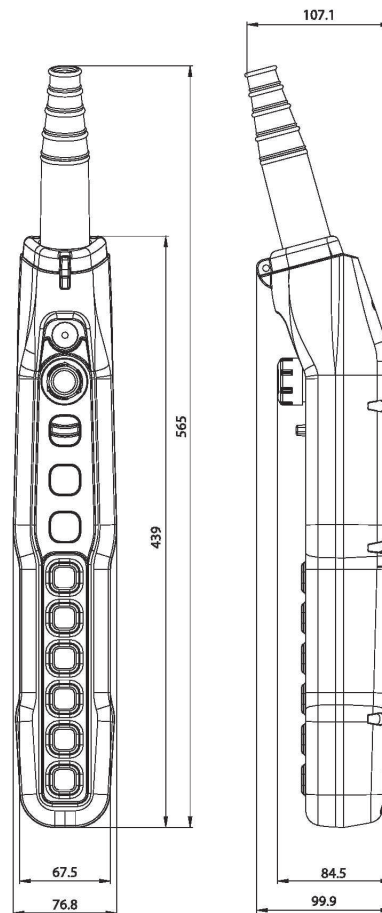

호이스트 스위치  
(Hoist switch)  
(KG-H10EPMHAAA)

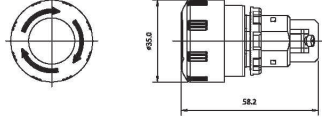

- 비상 스위치 (E)  
Emergency s/w
- 표시등 (P)  
Pilot lamp(POWER)
- 셀렉터 (M)  
Selector(MAIN-AUX)
- 누름버튼 (H)  
Push button(HORN)

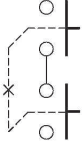
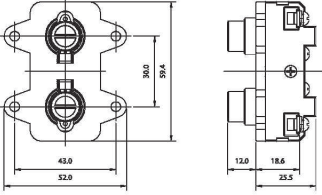

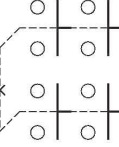
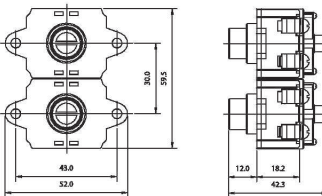
접점 사양 및 외형도 (Contact part composition & Dimension)

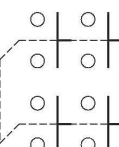
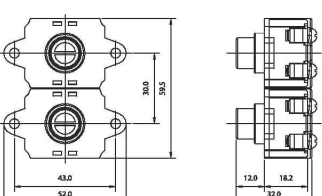
형 명 (Name)	접점블록 (Contact block)	접점구성 (Block composition)	정 격 (Rating)	외형도 (Dimensions)
KG-HE100 (1b)			6A 250V	
KG-HA100 (1a-1a, 1단) (1a-1a, 1stage)			6A 250V	
KG-HC100 (2a-2a, 2단) (2a-2a, 2stage)			6A 250V	
KG-HT100 (2a-2a, 1단) (2a-2a, 1stage)			6A 250V	

문자의 종류 (Push button with international symbols)

한글 (Korean)



영문 (English)



기호 (Symbol Marks)

